



# CROWNE PLAZA®

HOTELS & RESORTS

THE PLACE TO MEET.

CATALINA AVENUE

BERYL AVENUE

HARBOR BOULEVARD

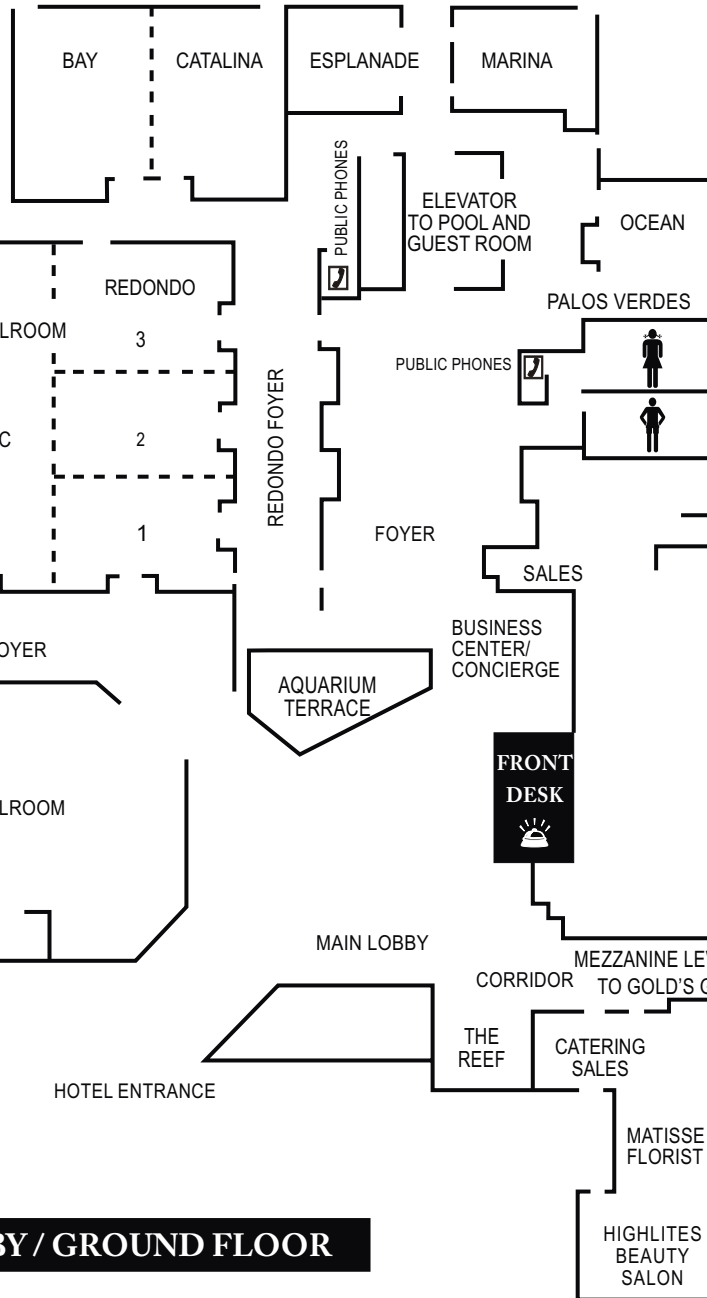

## LOBBY / GROUND FLOOR

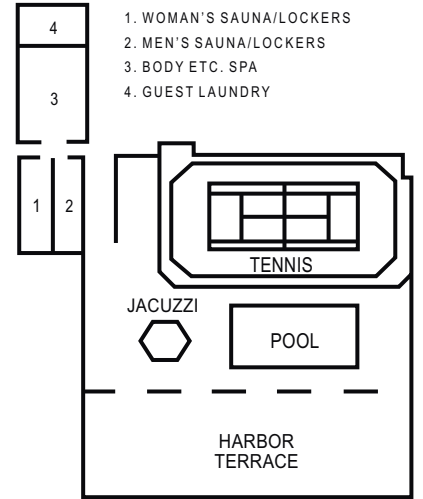

## SECOND LEVEL

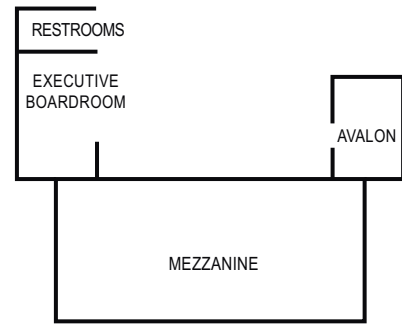

## MEZZANINE LEVEL

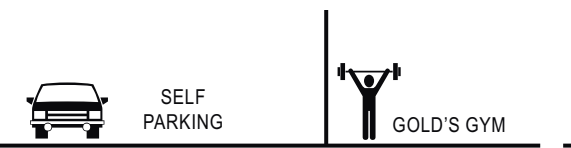

1. WOMAN'S SAUNA/LOCKERS
2. MEN'S SAUNA/LOCKERS
3. BODY ETC. SPA
4. GUEST LAUNDRY



**Coral Ballroom**  
Our superior facilities, combined with an experienced planning and coordinating staff, ensure that your meeting will be a success at the Crowne Plaza Redondo Beach & Marina Hotel



# CROWNE PLAZA®

## HOTELS & RESORTS

**THE PLACE TO MEET.**

# Why Go Anywhere Else?



**Executive Boardroom**

The Executive Boardroom offers a luxurious upscale setting for the private and important meeting, complete with executive amenities, a lounge and special services

Room	Dimensions Ft	Sq. Ft.	Height Ft.	Capacity of People per Set Up						
				Reception	Banquet	with Dance Floor	Theater	Classroom	Conference U-Shape	Exhibit (8' x 10')
Coral Ballroom Foyer		3500	13	400						
Redondo Foyer		1500	13	200						
CORAL BALLROOM	94x80	7250	13-15.5	1000	580	500	900	400		40
Peninsula, Pacific, Redondo (ea)	31x80	2480	13	300	180	140	250	115	50	12
Redondo Salon 1	30x40	1200	13	100	50		90	50	40	
Salon 2 & 3	30x40	1200	13	100	30		40	25	45	
SEASCAPE BALLROOM*	70x52	3640	12	320	250	180	150	90	46	20
Bay, Catalina (ea)	38x26	988	11.5	75	60		80	40	30	
Bay & Catalina (combination)	38x52	1976	11.5	175	120	80	130	60		
Esplanade, Marina (ea)	25x21	252	11.5	35	30		40	24	24/20	
Ocean	24x25	600	11.5	45	40		40	20	24/16	
Palos Verdes	13x29	377	11.5	25	20		30	10	15 (conf. set only)	
Mezzanine*	68x31	1900	8	175	100	80	90	50	40/34	
Avalon	17x15	255	8		12					
Executive Boardroom	29x19	551	8		16					
Splash Bistro					140					
Splash Show Kitchen					50					
Private Dining Room									17 (conf. set only)	
Patio					40					
Harbor Terrace*	136x46	6256		600	450		550			
*Ocean View				*Ballroom capacity does not include elaborate staging						
**All functions booked on Harbor Terrace must have approval of the Director of Catering				**All Classroom standard sets are based on 3 attendees per 6' table.						